



Flat 2, St Omers House 28 - 32 Elm Grove, Portsmouth, PO5 1JA

£825 PCM Council Tax Band A Deposit £951



1



1



1



D

Tully's

Floor Plan

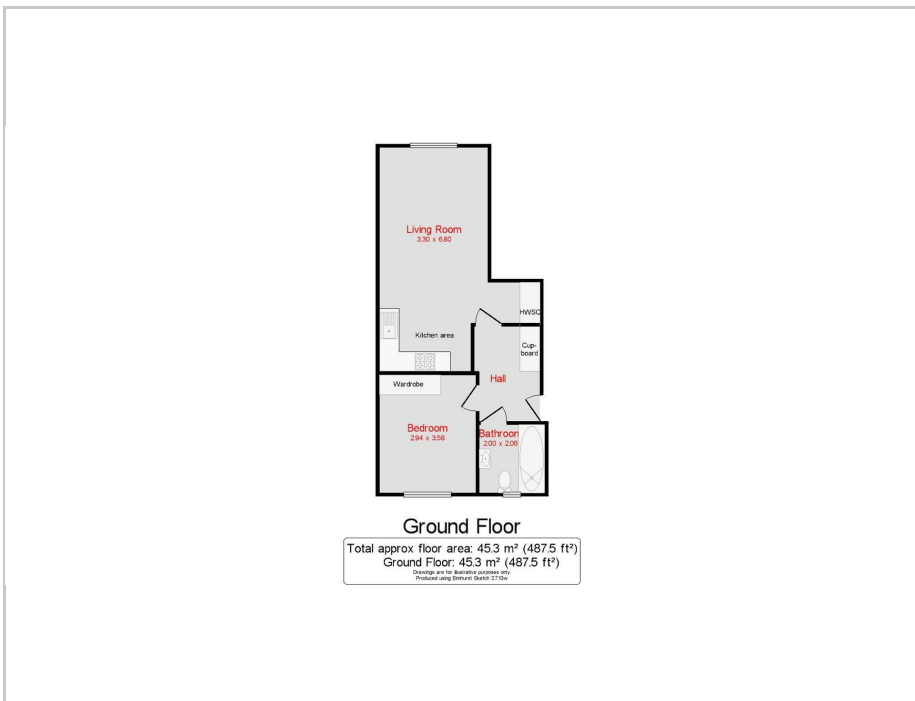

Area Map

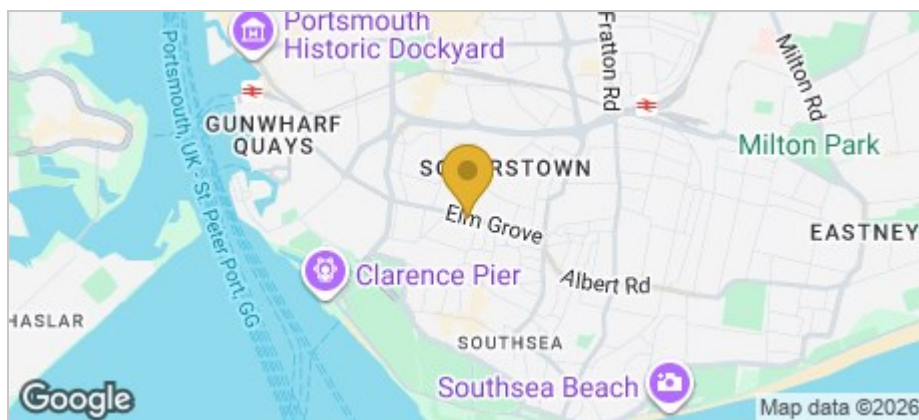

Accommodation

- H/Deposit - £190.00
- Deposit - £951.00
- Council Tax Band - A
- Available from 12/02/2026
- Parking Space Included
- 1 Bedroom
- 1 Reception
- 1 Bathroom
- Electric Heating

Viewing

Please contact our Southsea Office on 023 9273 2241 if you wish to arrange a viewing appointment for this property or require further information.

Energy Efficiency Graph

